

- Output Connection Type "A"

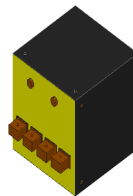

- Output Connection Type "B"

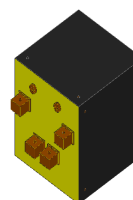

Power Rating Range (S_{50}) from 25kVA to 180kVA

- Output Connection Type "B/2"

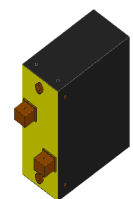

Power Rating Range (S_{50}) from 32kVA to 63kVA

Trasformatori tipo "A" - "B" - "B/2" per saldatrici multipunto (50/60Hz) secondo norma ISO 5826, DIN 44766

Type "A" - "B" - "B/2" Multiwelding Transformers (50/60Hz) according to ISO 5826, DIN 44766 standards

| Type | No load secondary voltage - U_{20} (V) | Max. mechanical dimensions $W \times H \times D$ (mm) | Mounting hole distances (mm) | Permanent output current - I_{2p} (kA) | Permanent output power - S_{2p} (kVA) | Output power at 50% duty cycle - S_{50} (kVA) | Approx. weight (kg) | Colour |
|------|------------------------------------------|-------------------------------------------------------|------------------------------|------------------------------------------|-----------------------------------------|-------------------------------------------------|---------------------|--------|
| A | 2,5 - 2,8 - 3,2 - 3,6 | 184 x 235 x 355 | 180 | 5 | 18 | 25 | 60 | brown |
| A | 3,6 - 4,0 - 4,5 - 5,0 | 184 x 235 x 400 | 224 | 5,6 | 28 | 40 | 70 | red |
| A | 5,0 - 5,6 - 6,3 - 7,1 | 184 x 235 x 450 | 280 | 6,3 | 45 | 63 | 90 | green |
| A | 7,1 - 8,0 - 9,0 - 10,0 | 184 x 235 x 560 | 400 | 7,1 | 71 | 100 | 110 | yellow |
| B | 2,5 - 2,8 - 3,2 - 3,6 | 184 x 235 x 355 | 180 | 5 | 18 | 25 | 60 | brown |
| B | 3,6 - 4,0 - 4,5 - 5,0 | 184 x 235 x 400 | 224 | 5,6 | 28 | 40 | 70 | red |
| B | 5,0 - 5,6 - 6,3 - 7,1 | 184 x 235 x 450 | 280 | 6,3 | 45 | 63 | 90 | green |
| B | 7,1 - 8,0 - 9,0 - 10,0 | 184 x 235 x 560 | 400 | 7,1 | 71 | 100 | 110 | yellow |
| B/2 | 5 - 5,6 - 6,3 - 7,1 | 92 x 235 x 595 | 280 | 3,2 | 23 | 32 | 50 | green |
| B/2 | 7,1 - 8 - 9 - 10 | 92 x 235 x 710 | 400 | 3,5 | 35 | 50 | 70 | yellow |

Standard accessories :

- Primary, Secondary, Rectifier NC Thermoswitches
- Output Current Sensing Coil, where prescribed of related standards

Special accessories on request :

- Embedded Temperature Sensor
- Output Voltage Sensing Wires
- Resistance or Fuse
- Tap Switch
- Primary Protection Cover IP55
- Multi Contact Primary Circuit Connectors
- Bus Distributor Box

Accessori di serie :

- Termostati per avvolgimento primario, secondario e gruppo di raddrizzamento
- Bobina di misura della corrente secondaria, dove prevista dalle relative norme.

Accessori speciali su richiesta :

- Sensori di temperatura incorporati
- Fili per il rilevamento della tensione d'uscita
- Resistenze o fusibili
- Commutatore
- Scatola di protezione lato primario del trasformatore IP55
- Connettori Multi Contact per il circuito primario del trasformatore
- Scatola di distribuzione Bus